



TECAPRES®

Ø75mm
3000daN

TITAN 75.1

VDI SAFETY



PED
2014/68/EU

COMPACT
EXTRA
POWER

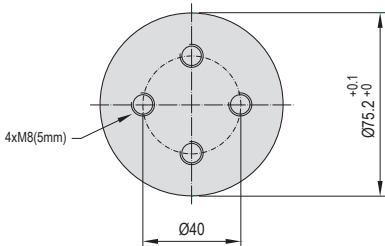
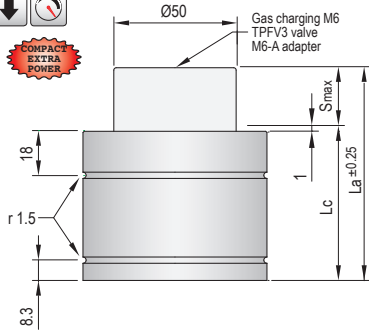

Pressure medium	Nitrogen (N ₂)
Max. charging pressure	150 Bar
Min. charging pressure	50 Bar
Rod seal area	19,63 cm ²
Operating temperature	0°C - 80°C
Force increase by temperature	0,33 %/°C
Max. stem speed	0,8 m/s
Maintenance kit	Kit T75.1



Maximum strokes / minute (at 20°C)

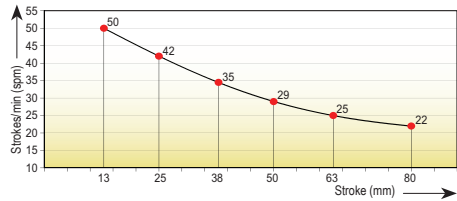

Code	Smax mm	La mm	Lc mm		Fa daN		F daN		Fc daN		P Bar	V l		Kg	
TITAN 75x12.1	12	61	49	3000 ±5% (20°C)	4650		4650		5160		150 (20°C)	0,056		1,25	
TITAN 75x25.1	25	87	62				4770		5330					0,112	1,39
TITAN 75x38.1	38	113	75				4810		5390					0,167	1,62
TITAN 75x50.1	50	137	87				4830		5420					0,219	1,72
TITAN 75x63.1	63	163	100				4840		5435					0,274	1,99
TITAN 75x80.1	80	197	117				4850		5455					0,347	2,18

Force/stroke ratio

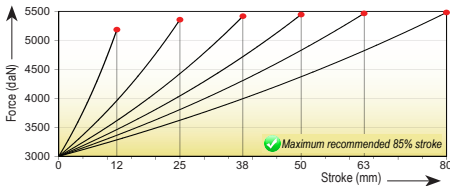

Initial force/charging pressure ratio

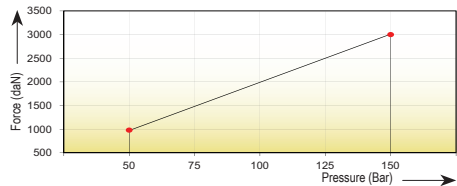

Assembly possibilities

Follow guidelines
Page 287

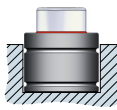

DROP-IN



SCREWS

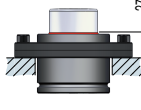

FSCS 75

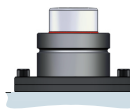

FSCS 75



FB 75

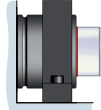

FI 75-F1 75/1

TITAN

TPH

TPS

TPSP

TPF

TPK

TPC

TPR

TPB

TPHC

TPA

TPG

TPCT

TPSL

STOP CYLINDER

STOP CYLINDER

TPSR

TPSR5

TPNS

TPHT

